

## Cooker hob KF Marine



Gas hobs

Code: 7666 962



### DETAILS

Edge/Installation Type	Standard (8 mm Edge)
------------------------	----------------------

Finish	Foster brushed
--------	----------------

Material	Stainless steel AISI 316
----------	--------------------------

Texture	Brushed in line
---------	-----------------

Supply	220-240 V; 50/60 Hz
--------	---------------------

Dimensions	760x500 mm
------------	------------

Base size	80cm
-----------	------

Heating element	Five burners
-----------------	--------------

Built-in hole	560x480 mm
---------------	------------

Grids	Cast iron grids and enamelled burner covers
-------	---

Width	76 cm
-------	-------

Total power	10.700 W
-------------	----------

Auxiliary	1.000 W
-----------	---------

Semirapid	2x1.750 W
-----------	-----------

Rapid	2.700 W
-------	---------

Triple crown	3.500 W
--------------	---------

Safety	Safety valve with quick-acting thermocouple
--------	---

Ignition	Electric ignition under knob
----------	------------------------------

Gas type	Tested for installation with natural gas, LPG nozzle set included.
----------	--

Type	Gas Hob
------	---------

## FEATURES

Under-knob ignition	The utmost freedom of movement with electronic under-knob ignition, a common feature of all models that allows a one-hand ignition of the burner.
---------------------	---

Marine stainless steel	The Marine collection of sinks and hobs uses AISI 316 stainless steel, a superior quality material and widely used in the marine industry, which guarantees the best resistance to the corrosive effects of acids contained in food, salt and detergents.
------------------------	---

## Special burners

Many Foster hobs are equipped with special burners, with two or three rings of fire that greatly increase the power delivered and the heated surface. In the DUAL models the two fire crowns also have independent ignition, making these burners perfect for both intensive and delicate cooking.

---

## Safe cooking

All Foster cooker hobs are equipped with safety valves. They shut off the gas supply very quickly if the flame accidentally goes out.

---

## Cast iron grids

Cast-iron is the ideal material for an hob grid, this due to the manifold properties characterising it: high heat capacity that improves cooking performance; high weight and stability that improve safety; sturdiness that preserves the hob's original aspect over time; easy cleaning.

---

## Ultra-flat hob

Design meets functionality in the the ultra-flat models. Elegant grids that form a generously sized overall surface.

---

## Narrow cut-out

These 5 burners products for standard built-in installation require a cut-out of only 56 cm, i.e. less than their nominal width. This makes them an interesting alternative for 60 cm models, which usually require the same cut-out.

---

## TECHNICAL DATA

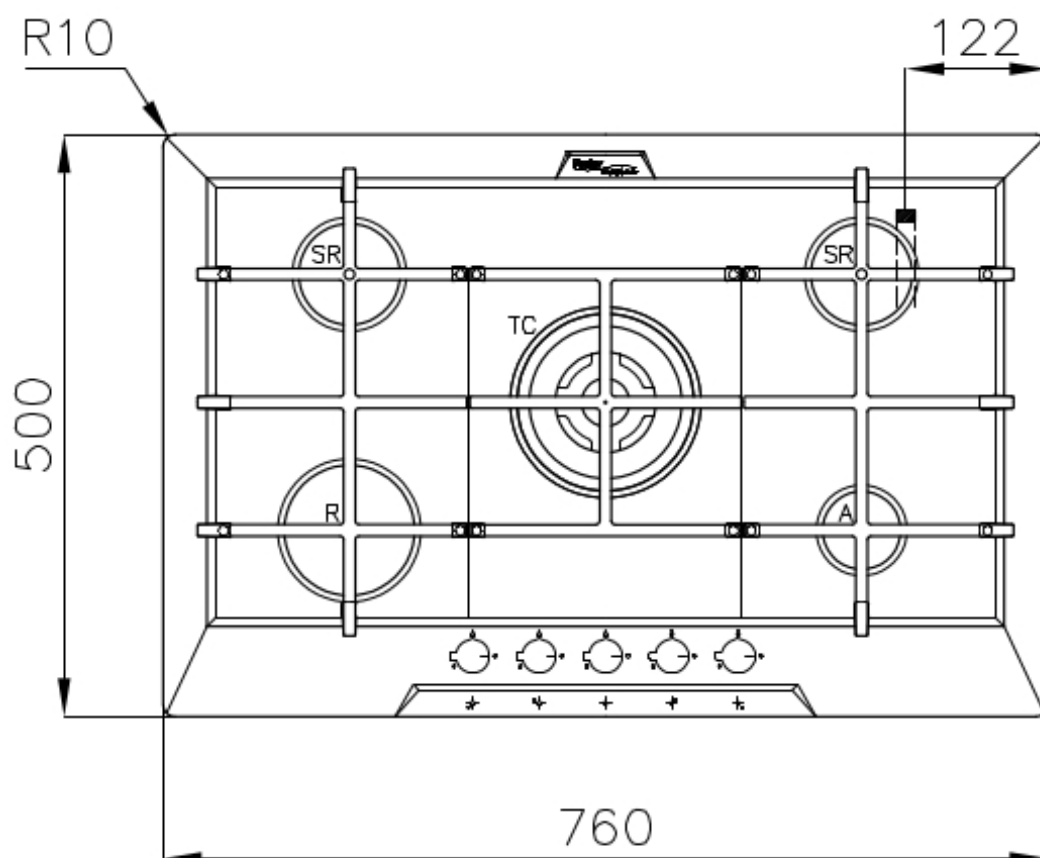
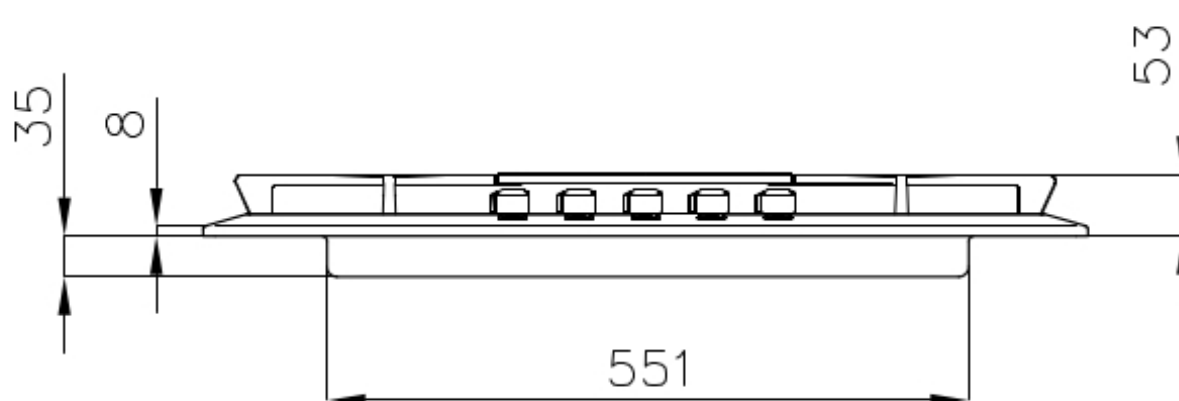

## OPTIONAL ACCESSORIES



**Cast iron wok support**  
9601 727

## RECOMMENDED PAIRINGS



**Hood KS Lux**  
2504 094